



Get WAY More. Live WAY Better.
Conaway Homes!

The Brooks

Tyler, TX ~ Whitehouse ISD

Carved from a hardwood forest, The Brooks at Cumberland Park is a delightful and serene retreat. Sidewalks meander along quiet curving streets. Parklands and quiet places to enjoy nature are intermingled among home sites. Residents of The Brooks enjoy City of Tyler amenities, quick access to South Broadway shopping and dining as well as Whitehouse Schools.

Tyler, TX ~ Whitehouse ISD

As of 02-07-12 8:33 AM

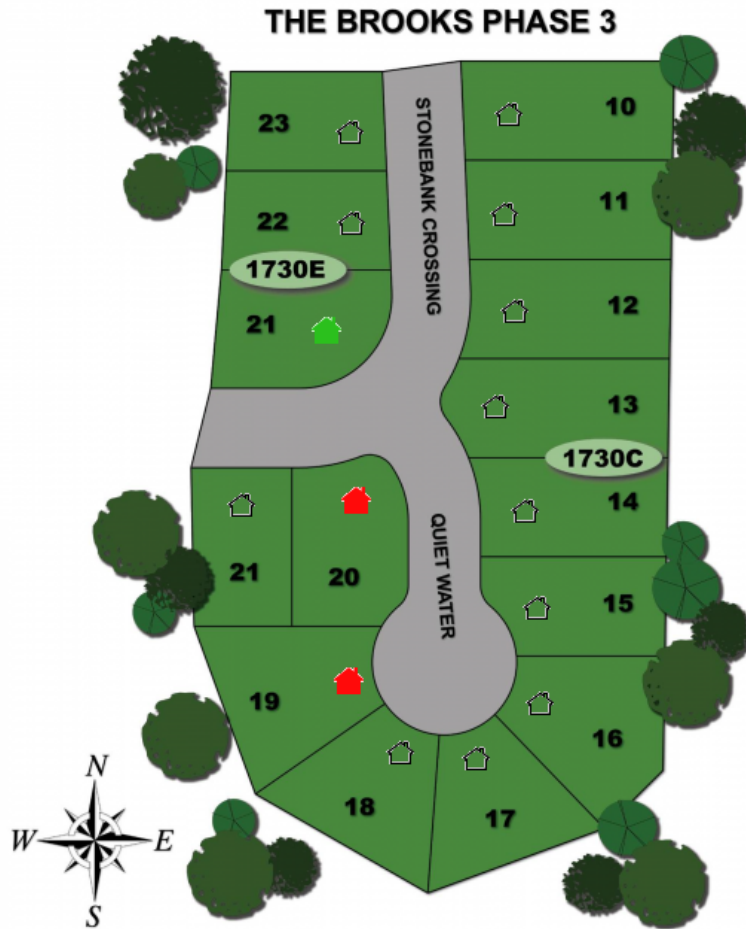

Floor Plan	Layout	From
Davenport - Hampton	3-4*/2/2	\$172,952
Easton - Belmont	3-4*/2/2	\$175,300
Edmond - Concord	3-4*/2/2	\$177,159
Fairfax	3-4*/2/2	\$181,478
Hartford - Roanoke	3-4*/2/2	\$198,556
Jackson - Bradford	5/2.5/2	\$214,549
Joliet - Meridian	4-5*/2.5/2	\$219,203
Kerrville - Trenton	5/3.5/2	\$226,970



Hello, I'm Charlotte Watson Bergami.
How may I assist you?
903-330-0007
charlotte@conawayhomes.com

