



Available Home

Southridge in Jacksonville

Experience is Everything™

The address for quality and value is Southridge. Ideally located across from Nichols Green Park, Southridge offers easy access to S. Jackson Street's dining & shopping. These cozy, new homes in Jacksonville, TX, are perfect for families of all sizes. The community features curbed & guttered streets, city sewer & water utilities, and is located in Jacksonville ISD. SOUTHRIDGE - HIGHLIGHTS Great location in Jacksonville Easy access to S. Jackson St., dining & shopping Curbed & guttered streets City sewer & water utilities Jacksonville ISD Preferred lenders to help get you qualified Award winning management team Dedicated personal building team Several plans to choose from Personalize with available features Energy Efficient HERS Rated home Full privacy fence with 4' & sidewalks All other

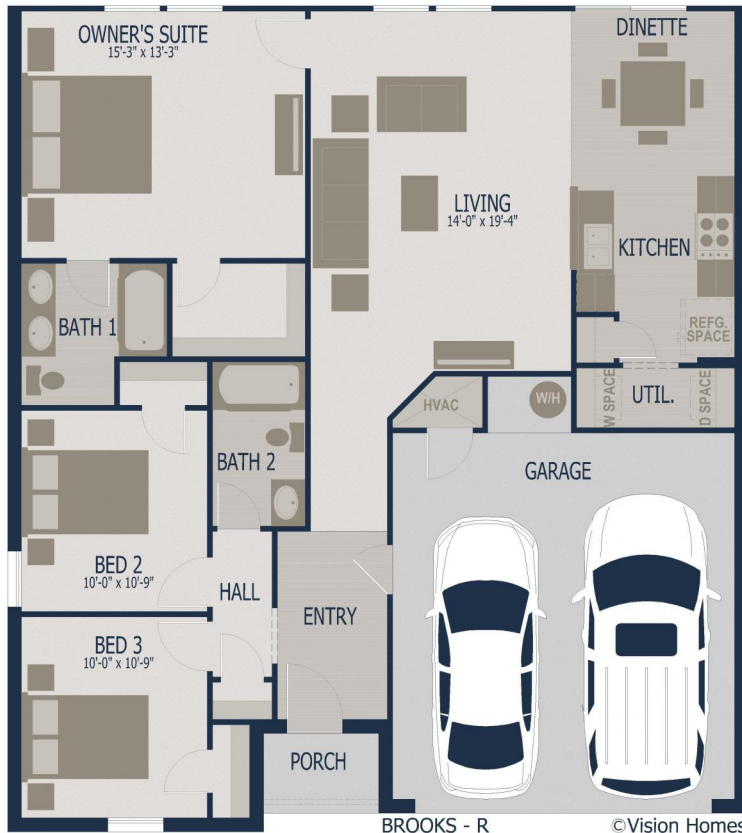

No Wheels Under Our Deals (TM) Site built by Vision Homes Solid concrete foundation 9' & #39; raised ceilings throughout Moisture controlling house wrap HERS rated energy efficient home Low-E, tilt-sash vinyl windows R-32 insulated ceilings Energy saving appliances 14 SEER air conditioning unit 1, 2 & 10 year builder warranty Plus much more...

Job #: 2470-06-V2
 Address: 108 Summit Cove
 School District: Jacksonville ISD
 Move in Date: Today



Hello, I'm Rick Oliver.
Sales2@conawayhomes.com
530 SH Loop 281
Longview, TX 75601

