



Joliet-II

Experience is Everything™

4-5 Bedroom / 2.5 Bath / 2 Car Garage
2,860 sqft. Heated & Cooled / 3,414 sqft. Under Roof

Plan Features... 4-5* Bedrooms, 2.5 Bathrooms, 2 car garage Formal Dining & Study Functional Kitchen with island and serving bar Extremely open Kitchen, Living, Breakfast rooms 2 story sloped ceiling in Living area Master bath with huge walk in closet 2nd floor Playroom with oversized closet

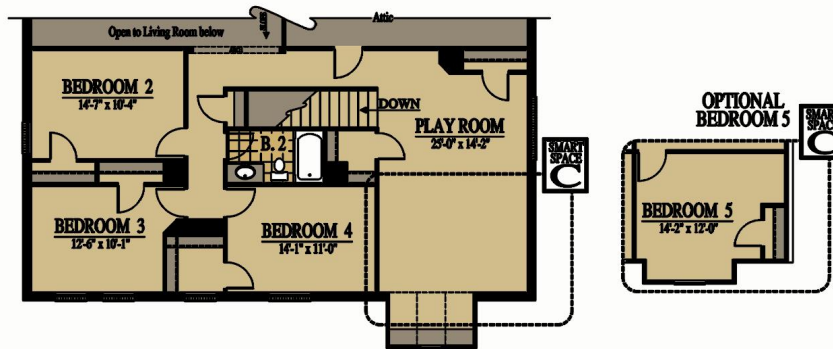

2nd. Floor



Available Elevations

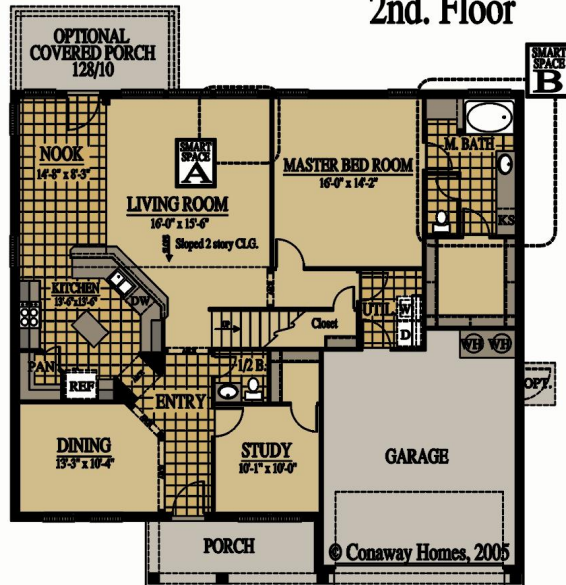

Contact Us
info@conawayhomes.com
1-855-CONAWAY (266-2929)

